



## A-Liner Pop-up Travel Trailer - \$99 per night

Sleeps 4 adults, the couch folds down to sleep two, and the table folds down to sleep two. The A-Liner has a sink, stove and heater that both run on propane (some battery power is needed to turn on the heater), a microwave that runs on electric hook up or a generator, and a fridge that runs on propane, electric hook up or generator.

The A-liner has a 16 gallon fresh water tank. It has no grey or black water tank.

Requires a 2" ball and 7 pin round for light hook up. Tongue weight is 300 LBS and dry trailer weight is 1850 LBS.

Generator is included with rental

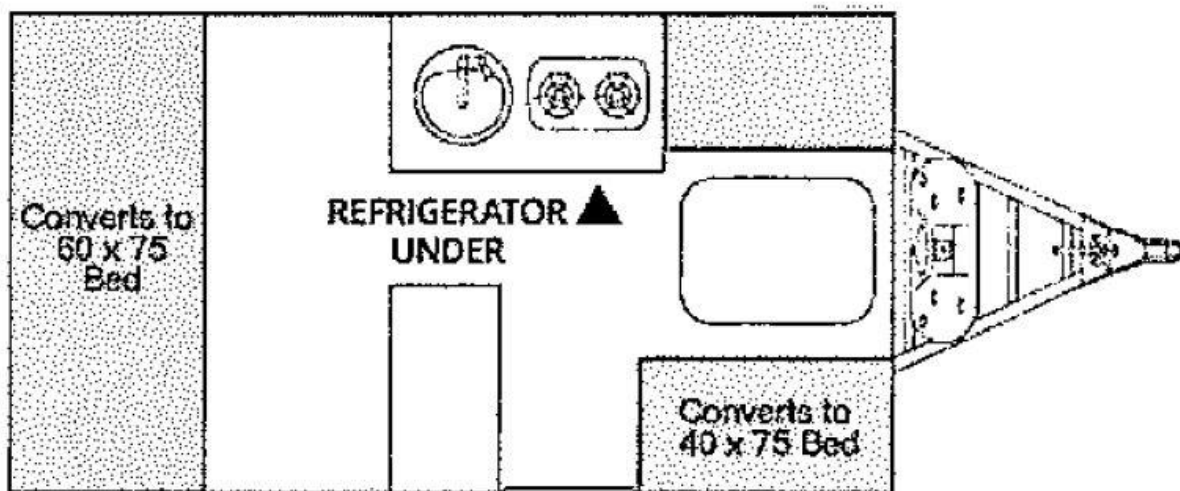

For more information, please call 552-2023.



## 16' Jayco Travel Trailer - \$119 per night

Sleeps 4 adults, the table folds down to sleep two and has a bunk bed\* that sleeps one person on each bunk. They include a stove, oven, microwave, refrigerator, and a full bathroom.

\*weight limit applies for top bunk

15 gallon grey water tank, 9 gallon black water tank, and 10 gallon fresh water tank.

Generator is included with rental.

Requires 2" ball and a 7 pin round for light hook up. Tongue weight is 305 LBS and the dry trailer weight is 2555 LBS.

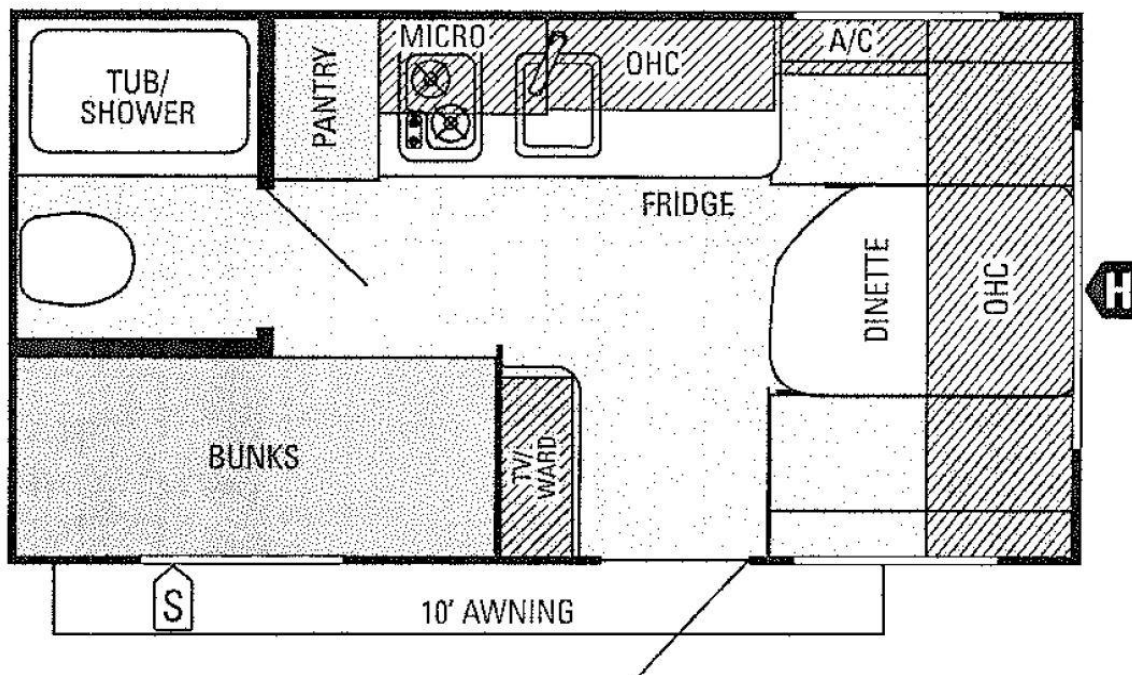

For more information, please call 552-2023.



## 16' R-Pod Travel Trailer - \$129 per night

Sleeps 4 adults, two different layouts available. Layout #1 – Queen size mattress and fold down dinette. Layout #2 – Fold down dinette with two bunk beds\*. They both include stove, oven, microwave, refrigerator, and a full bathroom.

\*weight limit applies for top bunk

Generator is included with camper

35 gallon gray water tank, 35 gallon black water tank, and 36 gallon fresh water tank.

Requires 2" ball and a 7 pin round for light hook up. Tongue weight is 244 LBS and the dry trailer weight is 2342 LBS.

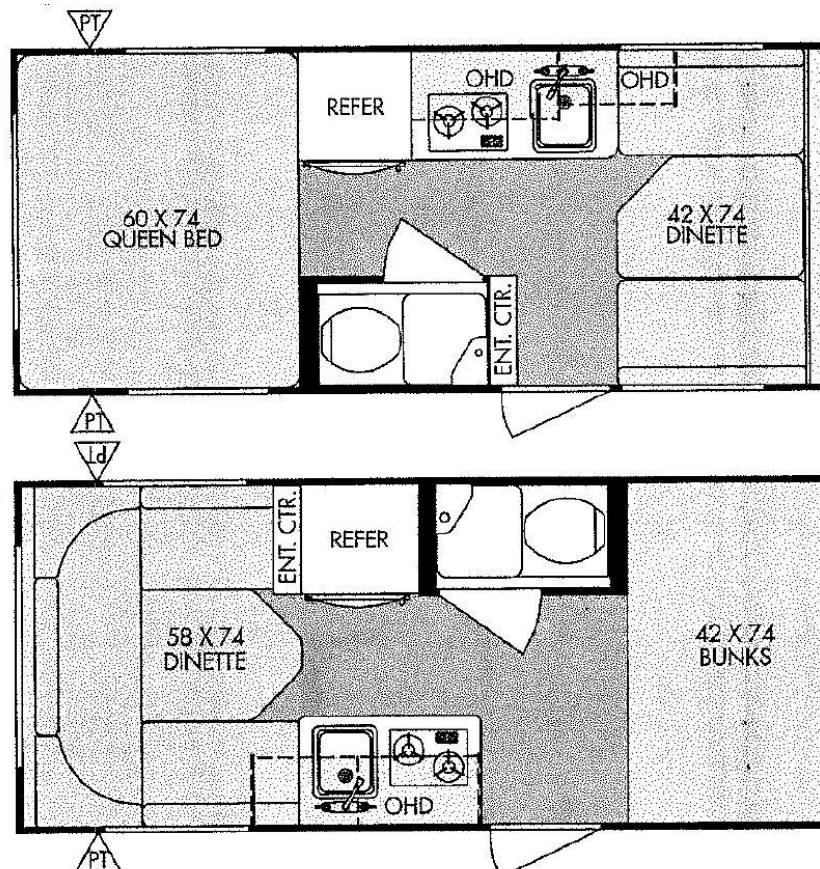

For more information, please call 552-2023.



## 18' Pioneer (Pet Friendly Camper)- \$119 per night

Sleeps 6, fold down dinette, full couch that folds down, full size bed, and bunk with max weight of 150 LBS. Includes stove, oven, microwave, refrigerator (can run on both electricity and propane), and a full bathroom.

Generator is included with camper

Contain 55 gallon fresh water tank, 35 gallon gray water tank, 35 gallon black water tank.

Requires 2" ball, and 7 pin round for light hook up. Tongue weight is 600 LBS and dry camper weight is 5000 LBS.

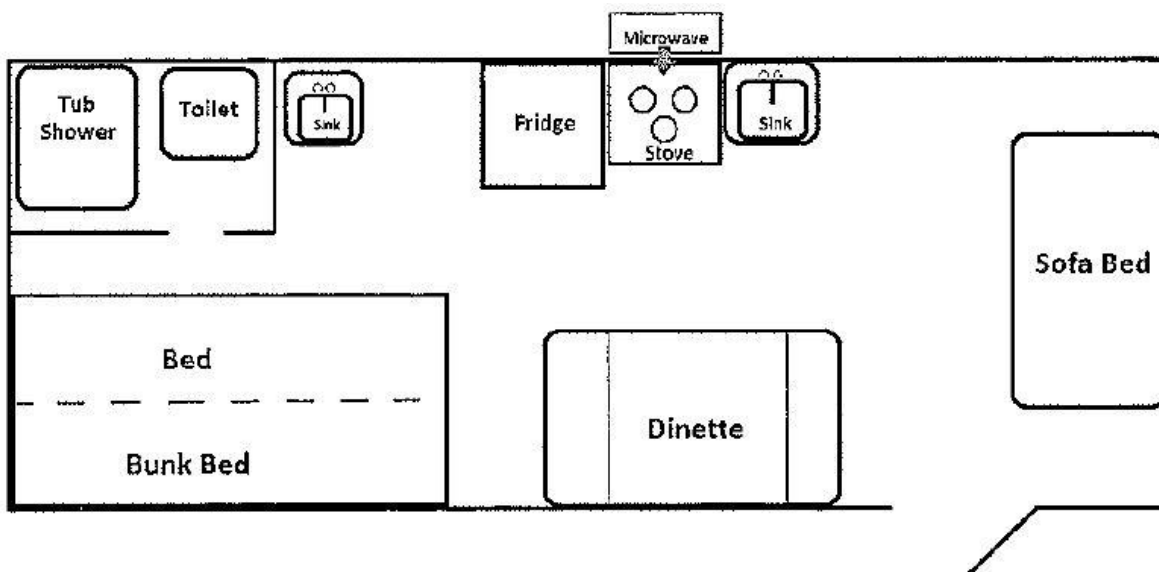

For more information, please call 552-2023.



## 19' Springdale Travel Trailers - \$129 per night

Sleeps 6, fold down dinette, full couch that folds down, full size bed, and bunk with max weight of 150 LBS. Includes stove, oven, microwave, refrigerator (can run on both electricity and propane), and a full bathroom.

Generator is included with rental

Both contain 55 gallon fresh water tank, 35 gallon gray water tank, 35 gallon black water tank.

Requires either 2" or 2 5/16" ball, and either 4 prong flat or 7 pin round for light hook up. Tongue weight is 600 LBS and dry camper weight is 5000 LBS.

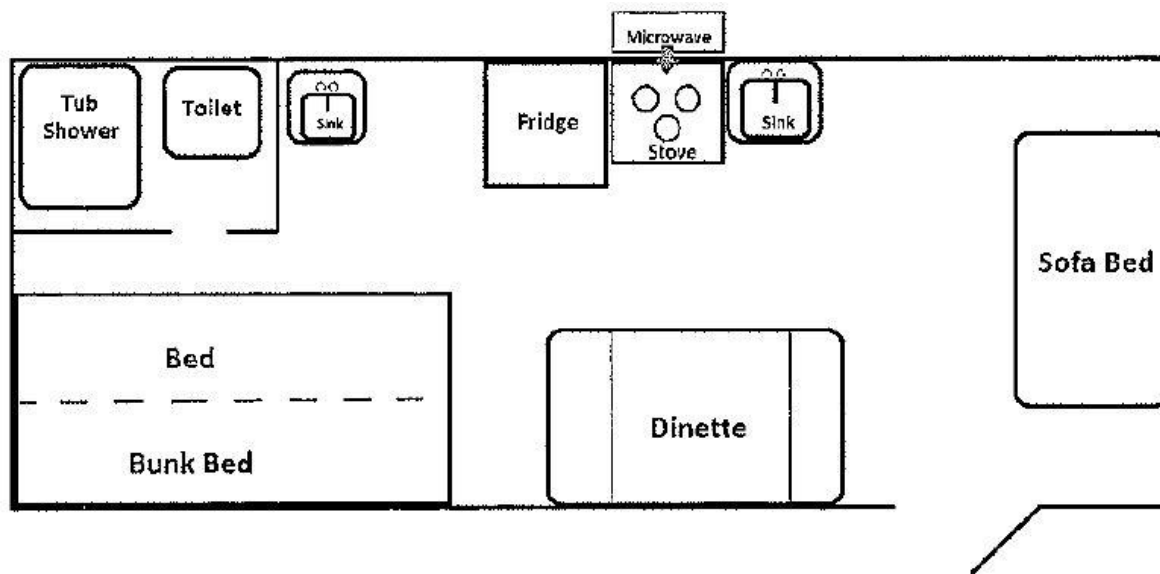

For more information, please call 552-2023.



## 20' Cruise Lite Travel Trailers - \$139 per night

Sleeps 6, fold down dinette, Murphy Bed, and bunk beds. Includes stove, oven, microwave, refrigerator (can run on both electricity and propane), and a full bathroom.

Generator is included with rental.

Contains 56 gallon fresh water tank, 30 gallon gray water tank, 30 gallon black water tank.

Requires 2 5/16" ball, and 7 pin round for light hook up. Tongue weight is 465 LBS and dry camper weight is 4173 LBS.

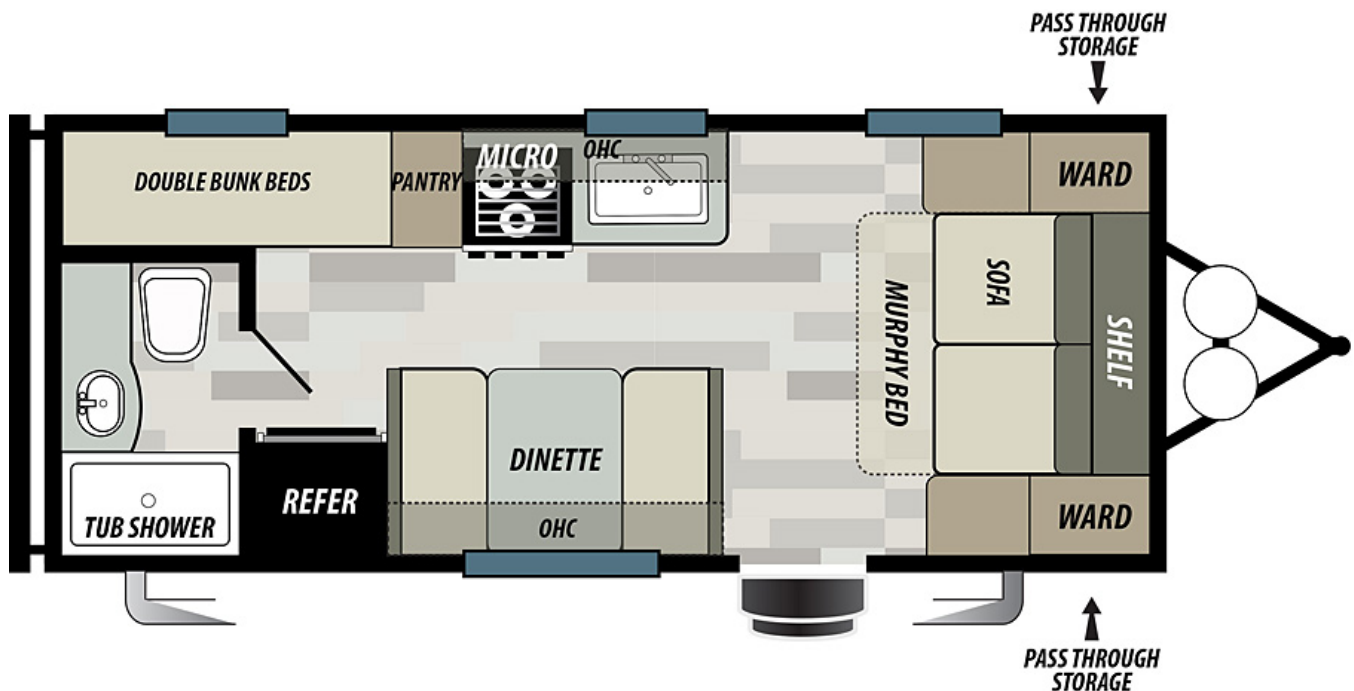

For more information, please call 552-2023.



## 23' Four Winds Class "C" Motorhome - \$199 per night (two night minimum)

Sleeps 5 (total of 5 seat belts). Master bedroom with queen size bed, fold down dinette, and cab over bunk bed. They include stove, oven, microwave, refrigerator (can run on both electricity and propane), self-contained generator, a standard television, and a full bathroom.

55 gallon fuel tank, 40 gallon fresh water tank, 24.5 gallon black water tank, and 38.5 gallon gray water tank. We do not allow towing of any trailer with our motorhomes.

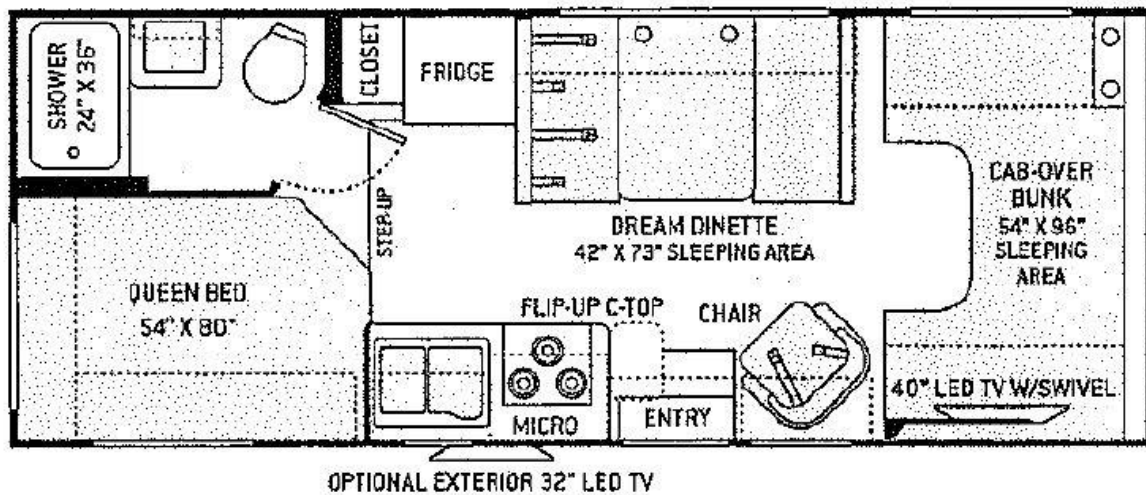

For more information, please call 552-2023.