



A-Liner Pop-up Travel Trailer - \$79 per night

Sleeps 4 adults, the couch folds down to sleep two, and the table folds down to sleep two. The A-Liner has a sink, stove and heater that both run on propane (some battery power is needed to turn on the heater), a microwave that runs on electric hook up or a generator, and a fridge that runs on propane, electric hook up or generator.

The A-liner has a 16 gallon fresh water tank. It has no grey or black water tank.

Requires a 2" ball and 7 pin round for light hook up. Tongue weight is 300 LBS and dry trailer weight is 1850 LBS.

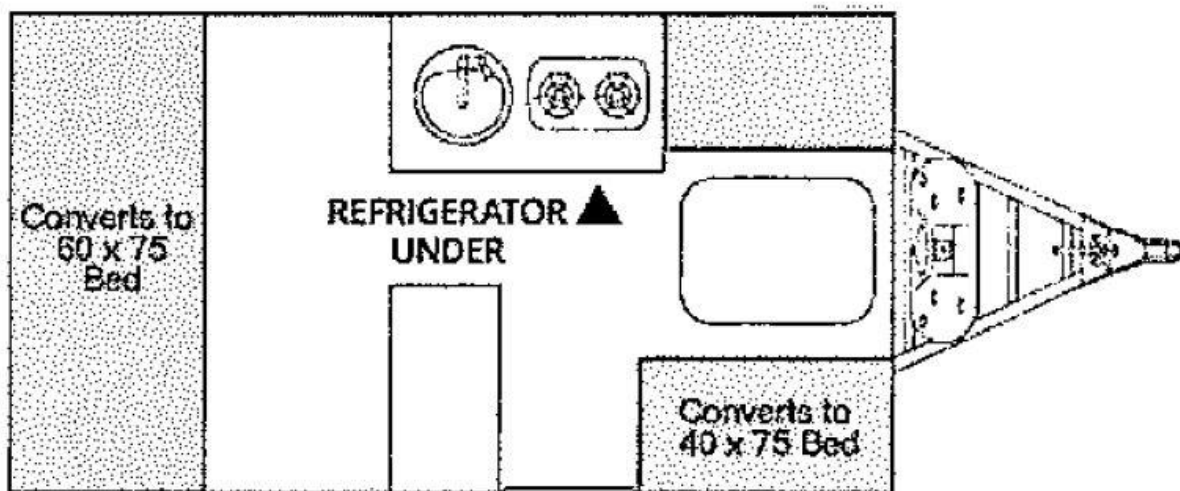

For more information, please call 552-2023.



16' Jayco Travel Trailer - \$99 per night

Sleeps 4 adults, the table folds down to sleep two and has a bunk bed that sleeps one person on each bunk. They include a stove, oven, microwave, refrigerator, and a full bathroom.

15 gallon grey water tank, 9 gallon black water tank, and 10 gallon fresh water tank.

Requires 2" ball and a 7 pin round for light hook up. Tongue weight is 305 LBS and the dry trailer weight is 2555 LBS.

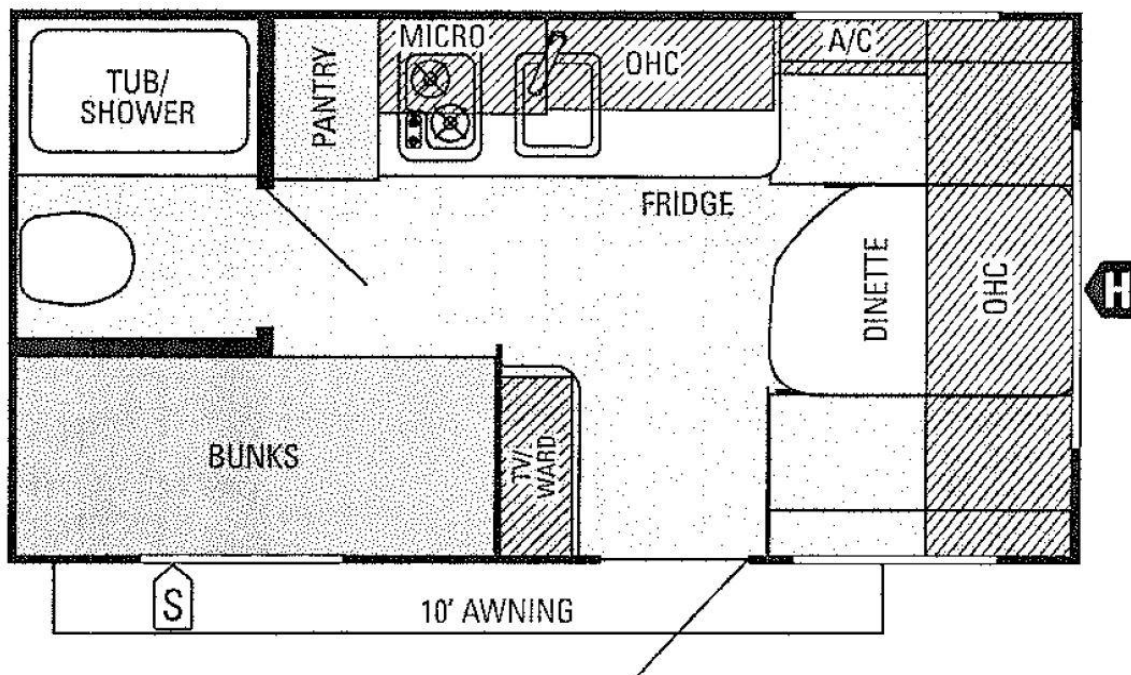

For more information, please call 552-2023.



16' R-Pod Travel Trailer - \$99 per night

Sleeps 4 adults, two different layouts available. Layout #1 – Queen size mattress and fold down dinette. Layout #2 – Fold down dinette with two bunk beds. They both include stove, oven, microwave, refrigerator, and a full bathroom.

35 gallon grey water tank, 35 gallon black water tank, and 36 gallon fresh water tank.

Requires 2" ball and a 7 pin round for light hook up. Tongue weight is 244 LBS and the dry trailer weight is 2342 LBS.

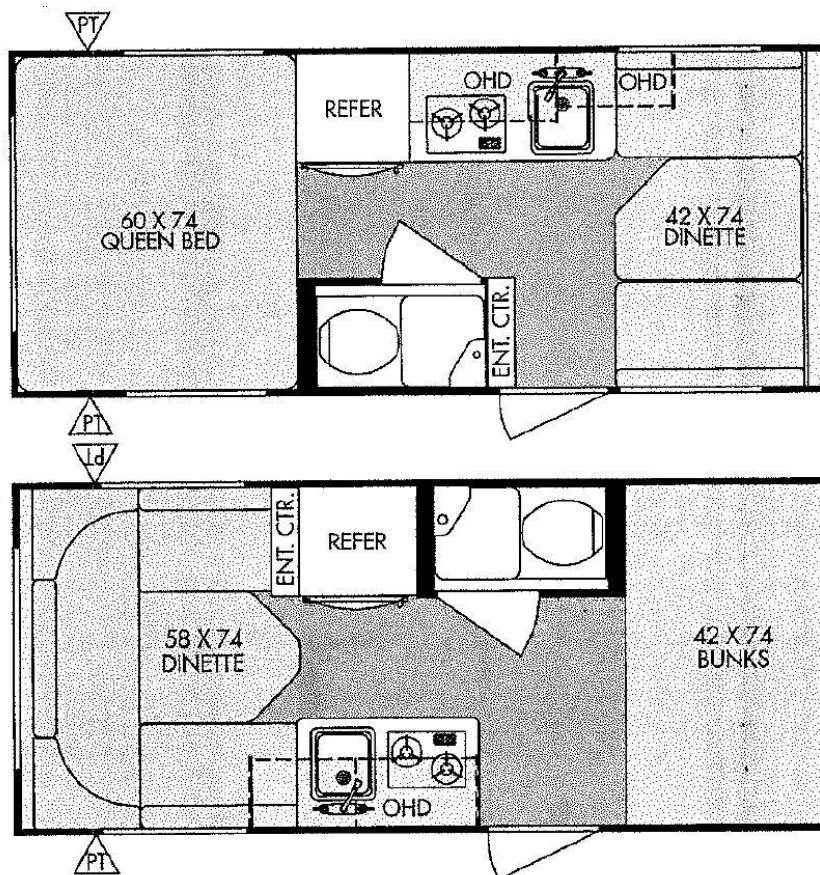

For more information, please call 552-2023.



18' Pioneer and 19' Springdale Travel Trailers - \$99 per night

Sleeps 6, fold down dinette, full couch that folds down, full size bed, and bunks with max weight of 150 LBS. They both include stove, oven, microwave, refrigerator (can run on both electricity and propane), and a full bathroom. *Pioneer and Springdale travel trailers have the same interior layout.*

Both contain 55 gallon fresh water tank, 35 gallon grey water tank, 35 gallon black water tank.

Requires either 2" or 2 5/16" ball, and either 4 prong flat or 7 pin round for light hook up. Tongue weight is 600 LBS and dry camper weight is 5000 LBS.

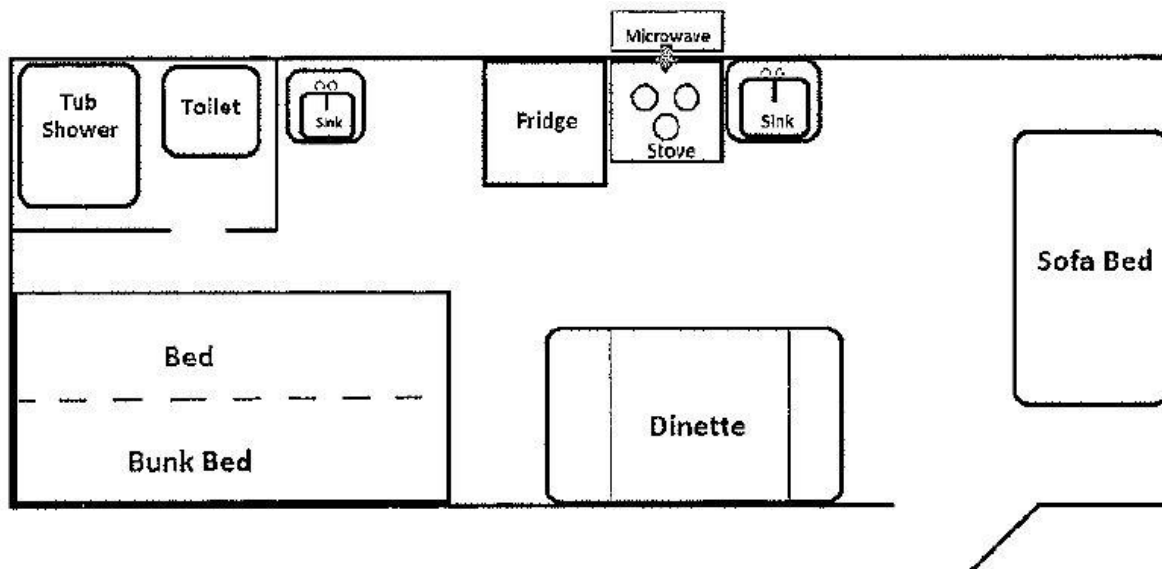

For more information, please call 552-2023.



31' Dutchman Class "C" Motor Home - \$225 per night (two night minimum)

Sleeps 7-8. Master bedroom with queen bed, fold down dinette, fold down couch, and overhead bunk. They include stove, oven, microwave, refrigerator (can run on both electricity and propane), self-contained generator, a standard television, and a full bathroom with shower detached from commode. The Dutchman also has a 2' slide out allowing for more room on the interior.

55 gallon regular unleaded fuel tank, 75 gallon fresh water tank, 50 gallon grey water tank, and a 50 gallon black water tank. We do not allow towing of any trailer with our motorhomes.

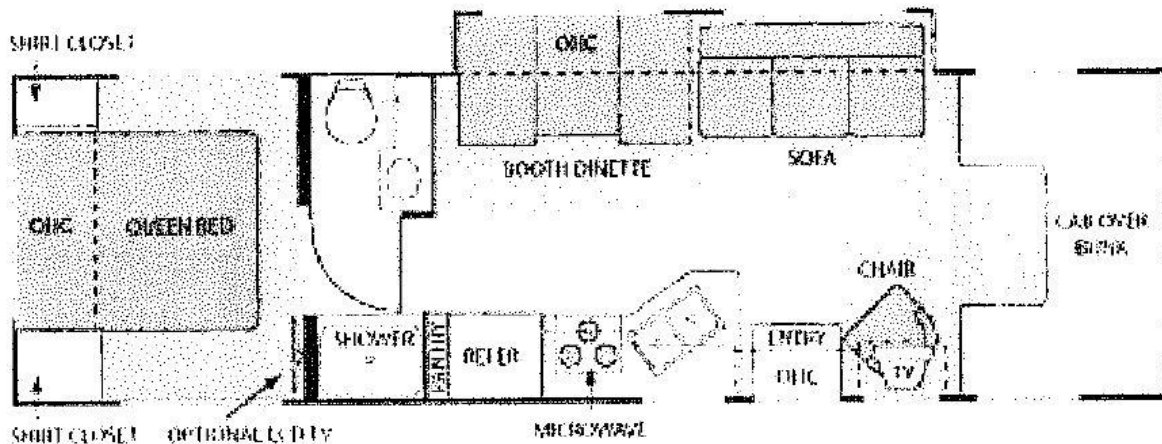

For more information, please call 552-2023.



23' Four Winds Class "C" Motorhome - \$199 per night (two night minimum)

Sleeps 5 (total of 5 seat belts). Master bedroom with queen size bed, fold down dinette, and cab over bunk bed. They include stove, oven, microwave, refrigerator (can run on both electricity and propane), self-contained generator, a standard television, and a full bathroom.

55 gallon fuel tank, 40 gallon fresh water tank, 24.5 gallon black water tank, and 38.5 gallon grey water tank. We do not allow towing of any trailer with our motorhomes.

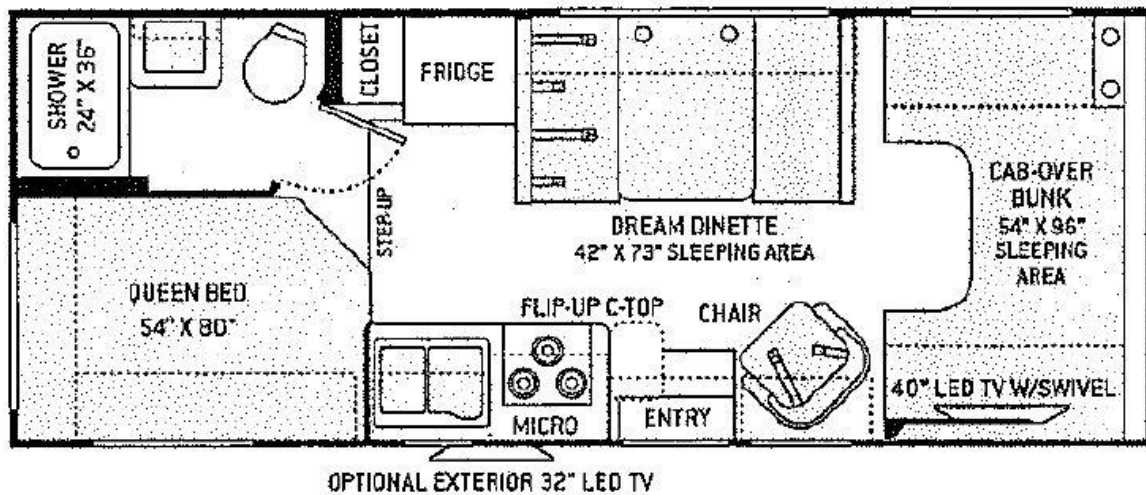

For more information, please call 552-2023.